

# KAOS Pocket

## Installation Instructions

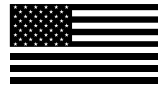

INSTALLERS: PLEASE LEAVE THIS MANUAL WITH THE OWNER.





Scan this QR code to refer to the warranty for this SI product.



Please use this QR Code to access the updated installation instructions and related documents on Zendesk or ask the AI chatbot.



Technical Support: 512.832.6939  
Hours of Support: 8am – 6pm CST

shadeinnovations.com  
techsupport@shadeinnovations.com

# TABLE OF CONTENTS

Before Proceeding	4
Parts In The Box	5
Bracket Installation	6
Shade Installation	7 - 9
Power and Programming	10
Recessed Tracks Installation	10
Measuring And Cutting U Channels And The V-Tracks	11
Tracks Installation	12
Securing Tracks	13 - 14
Fine Tuning And Tracking Management	14
Best Practices Summary	15
Troubleshooting	16

# BEFORE PROCEEDING

**⚠** Read the instructions in their entirety before proceeding. Actions contrary to the instructions voids the warranty and may result in serious damage and/or injury.

**Preparing for installation–** It is crucial that all installations are planned out carefully before specifying a shade order.

For recessed installations, U-channels are required before track installation. These can be installed, before your main shade is ordered.

Make sure that the tracks and the shade boxes can be installed securely, level, and plumb. Add appropriate blocking or carpentry work before installing tracks and shades.

Electrical work should be performed following appropriate electrical codes and regulations by a licensed electrical professional.

Use fasteners that are appropriate for the structure the KAOS shade will be mounted to.

Do not use any sharp blades when opening the packaging.

We recommend a pocket size of 7" W x 12" H.

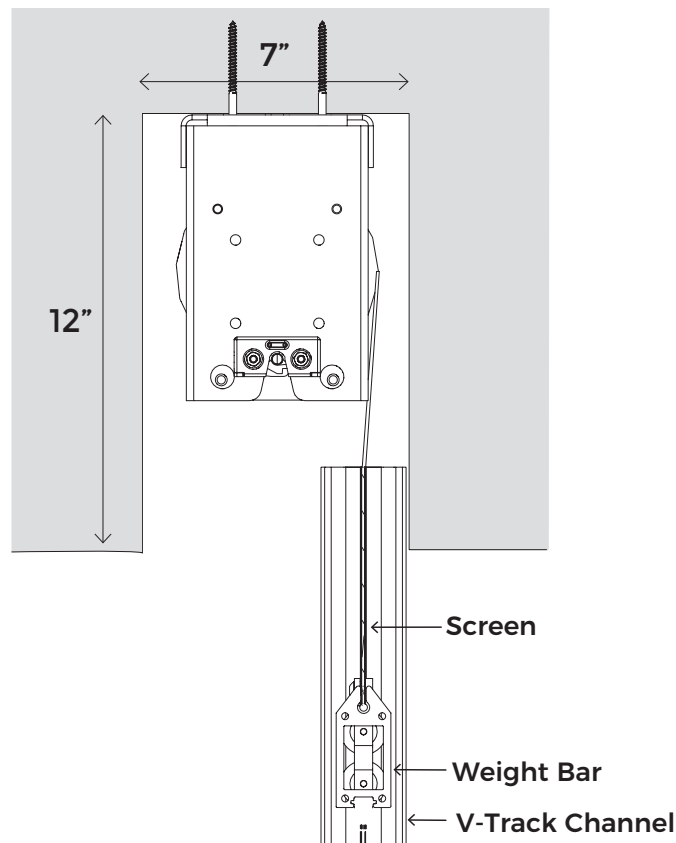

# PARTS IN THE BOX

## Shades

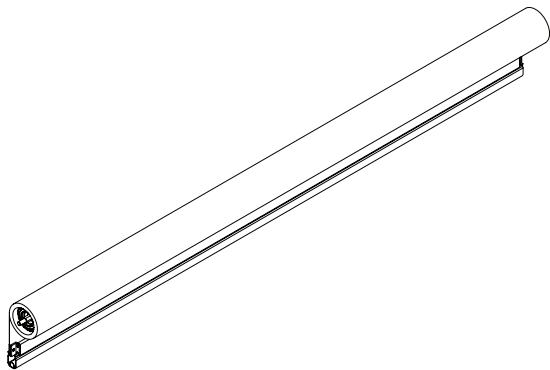

Shade assembly



(2) V-Tracks



(2) U channels

## Mounting Bracket Options

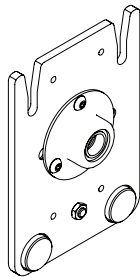

Idle Slider

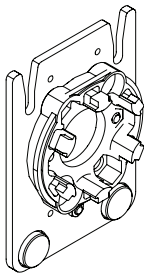

Motor Slider

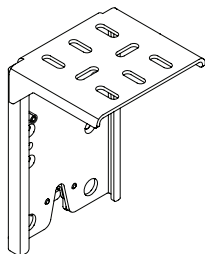

(2) Pocket Brackets

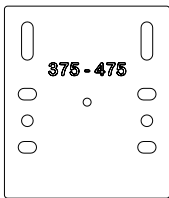

(6) Spacer Blocks  
Longer Screws

Note: Adds 3/4"

## Remote Accessories

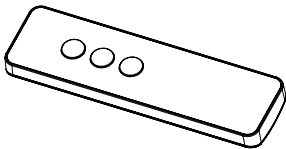

Remote

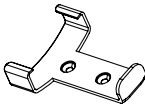

Remote Holder



AAA Batteries

**Note:** NEMA plugs are not included and must be sourced from a third party.

# BRACKET INSTALLATION

**BEFORE INSTALL** – check upper corners of the pocket as needed to ensure there are no interference issues with brackets.

- 1 Use appropriate fasteners to mount to the ceiling or wall 3/4" from the inside of the U-Channel. Reference the back plate of the mounting bracket, not the latch system for proper placement.

**NOTE:** Ensure the fasteners used are adequate for the weight of the KAOS Shade and the structure.

**Jam Mount**

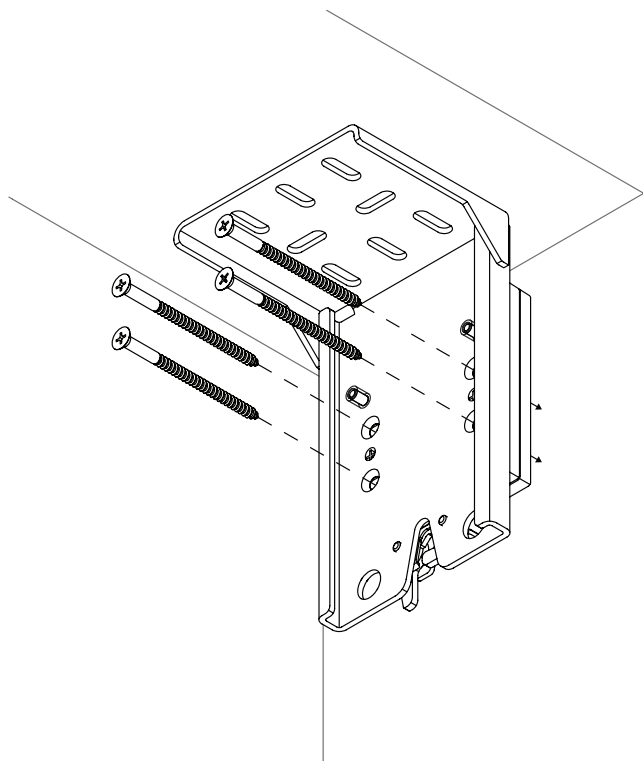

**Ceiling Mount**

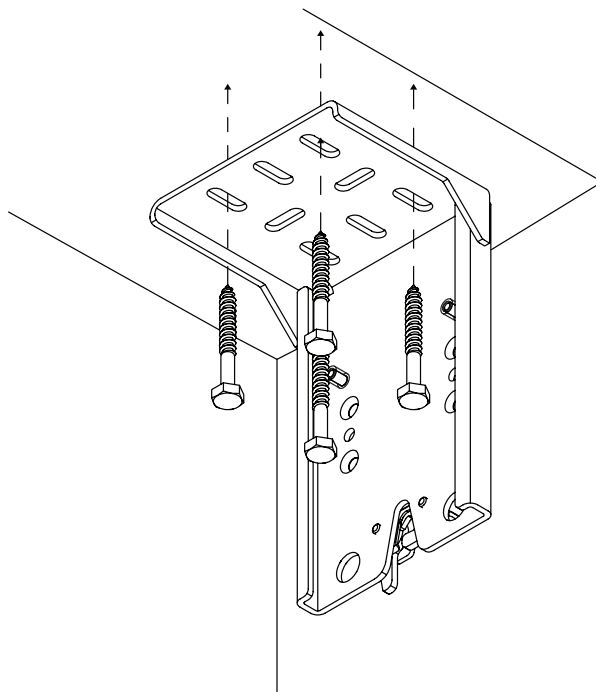

# SHADE INSTALLATION



2+

Installation requires two or more people and/or hoisting equipment.  
Please use safe lifting and rigging techniques.

2

Avoiding sharp tools, remove the roll from its packaging on a soft, clean surface. Discard any foam or excess packaging.

Place the bracket insert into the idler side first; motor side will “click” into place.

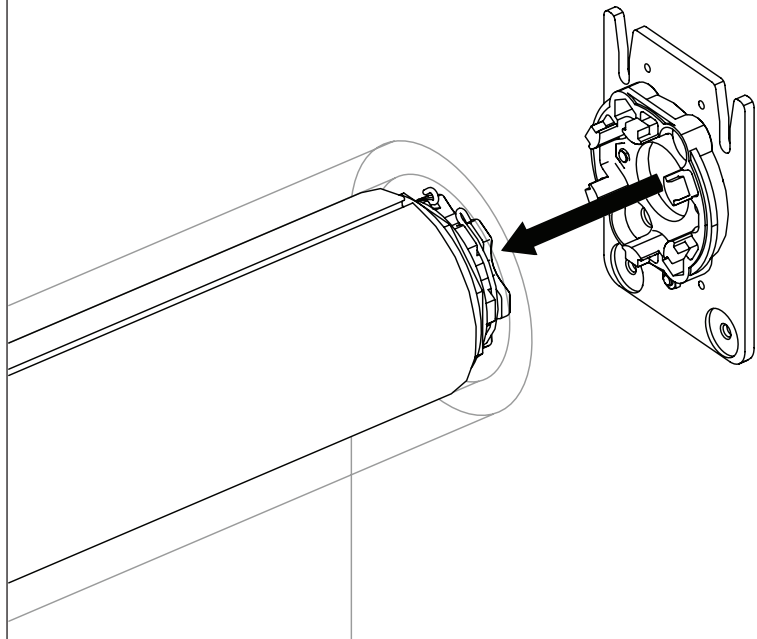
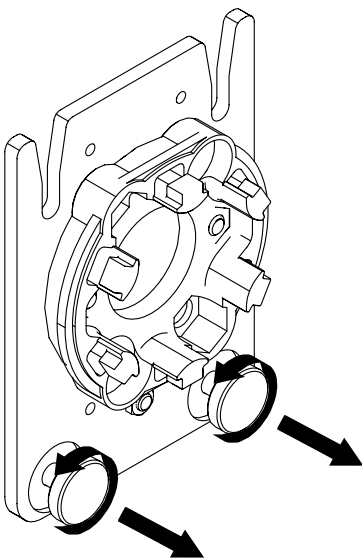
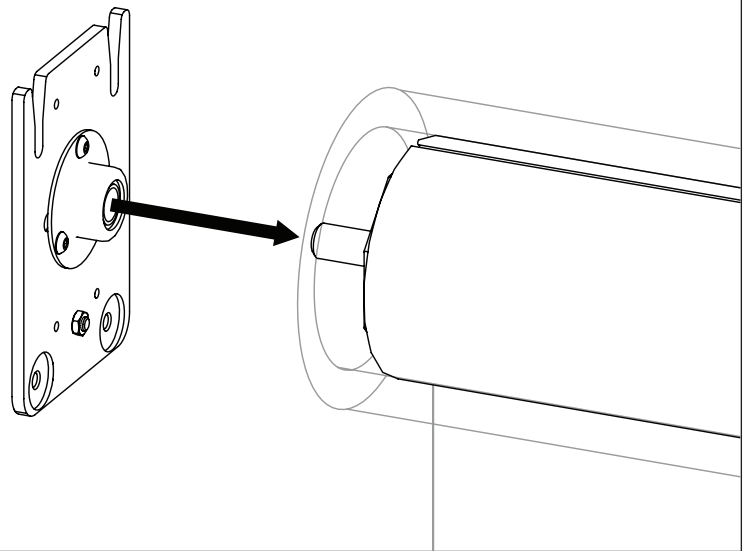
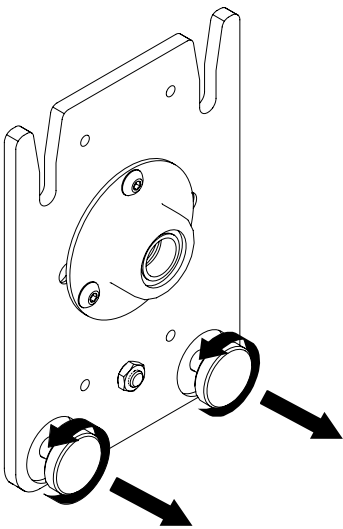

# SHADE INSTALLATION

## 3 Install the Fabric Roll

- a. Rest the bottom/weight bar on the 2 saw horses or small ladders.
  - **Best Practice:** In the absence of saw horses, you can rest the weight bar on the ground—use some of the packaging to prevent scratching on the finished surfaces.
- b. Completely unroll the fabric until you are working with the bare aluminum tube.

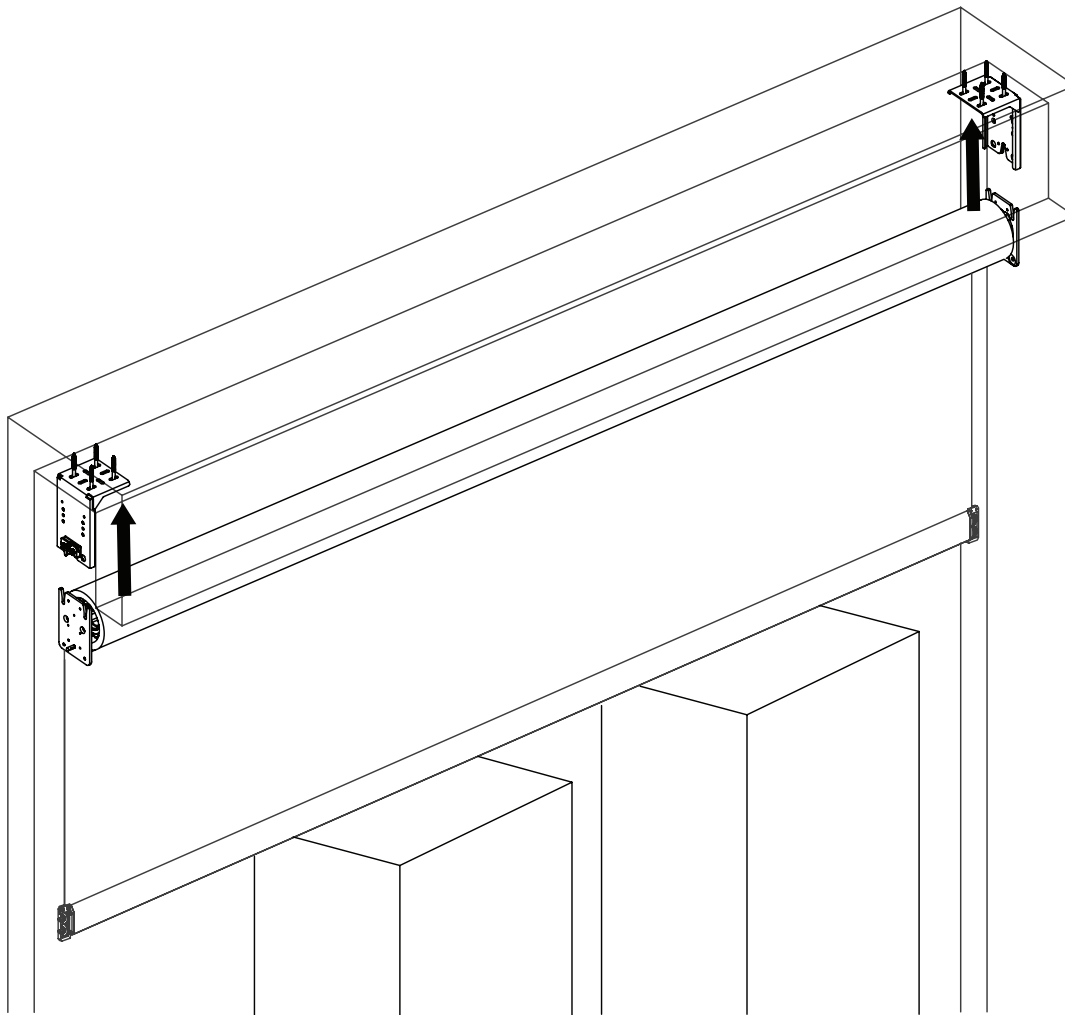



# SHADE INSTALLATION

c. Note the motor side and idler side.

- **Best Practice:**

- The idler plate can easily fall off laterally.
- The motor plate is secured on.
- Position the brackets so that they will be in the correct orientation for installation.

d. Position both sides under the pocket and push up into the pocket brackets simultaneously on the left and right.

- **Caution:** If one side goes in first, it can be difficult to get the other side in.
- **Note:** An audible click is heard when the shade is secured.

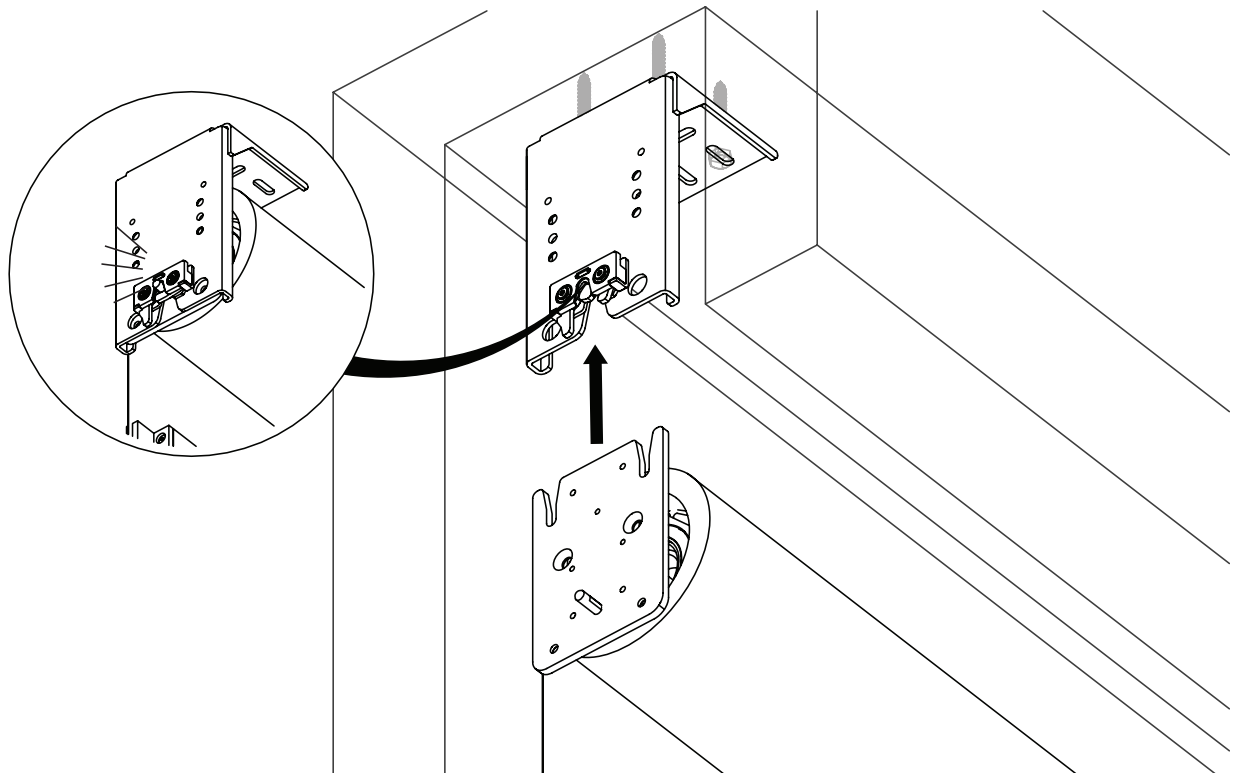

## SHADE INSTALLATION

- 3** e. Fasten the silver safety screws on the mounting plates to secure the material roll.

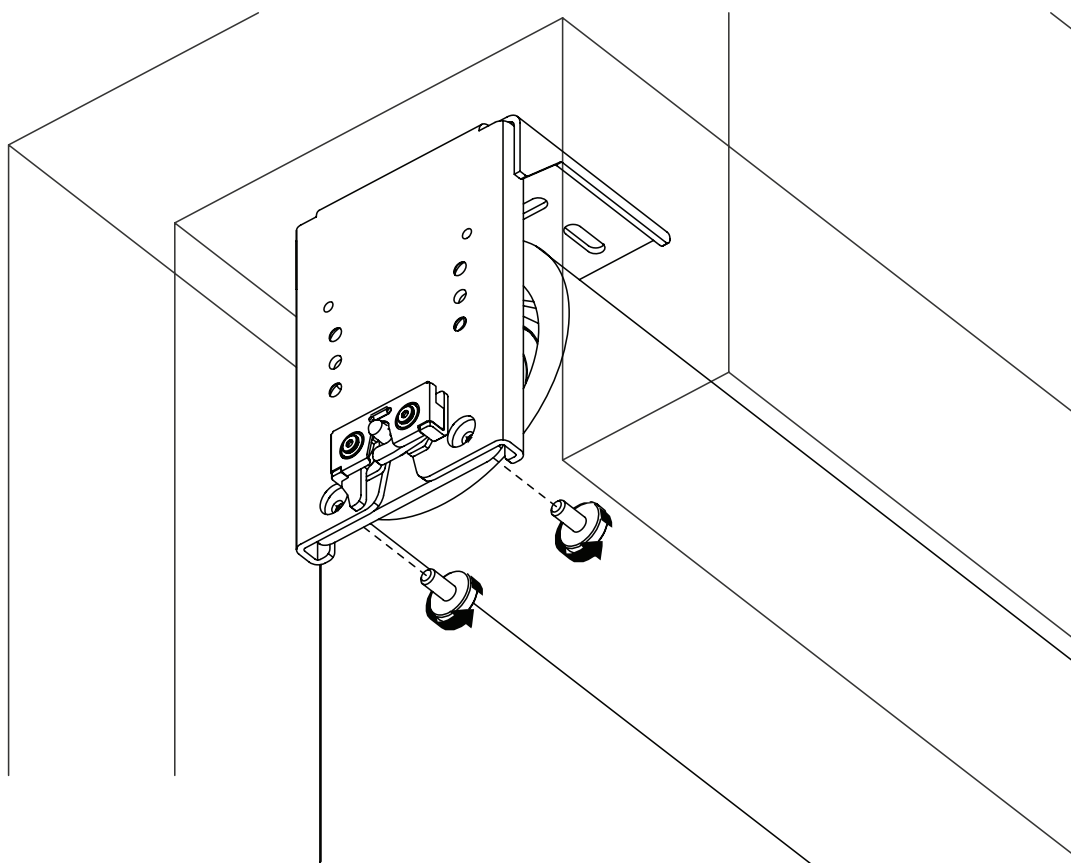

## POWER AND PROGRAMMING

Depending on the motor ordered with your shade, you will use one of the following Guides below, detailing how to program the motor.

### **SI KAOS Motor Programming Guide:**

Scan the QR code; alternatively, use this link to access:

<https://files.screeninnovations.com/Downloads/Programming+Guides/Shade/kaos-si-motor-programming-guide.pdf>



### **KAOS Somfy Motor Programming Guide:**

Scan the QR code; alternatively, use this link to access instructions and programming guide:

<https://files.screeninnovations.com/Downloads/Programming+Guides/Shade/kaos-somfy-motor-programming-guide.pdf>



## RECESSED TRACKS INSTALLATION



Please scan this QR code to refer to the Recessed Tracks Installation Instructions.

# MEASURING AND CUTTING U CHANNELS AND THE V-TRACKS

**NOTE:** - Tracks are labeled as Left and Right on the top side of the tracks.  
- The top of the tracks is indicated by the black “keeder feeder” and the removable “bumper.”

## 4 Measuring and Cutting Tracks & U channels:

- Measure the distance from the top of the opening to the floor.
- Subtract 1/2” from that measurement—this is the length the tracks need to be cut.
- Remove the bottom cap from each track.
- Cut the track to the length from Step b, trimming only the bottom end of the track (do not cut the top).

**Track Cut Length = (Distance from bottom of case to floor) – 1/2”**

Make sure to cut only the bottom end of the track to this length.

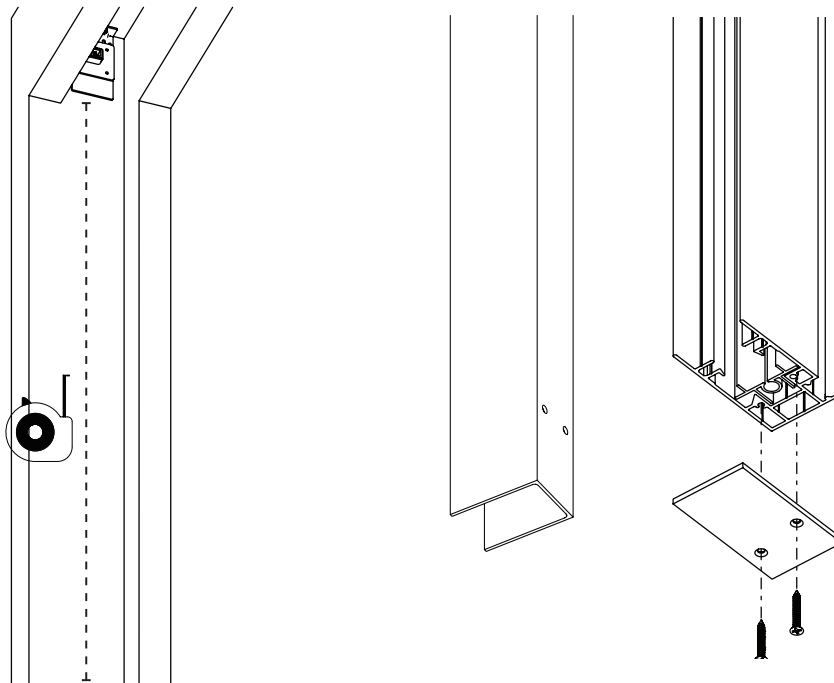

**Note:** - Eye protection is required!

- Repeat this process for each track. Only cut one at a time — cut then install — to prevent tracks from being mixed up and to maintain progress.

# TRACKS INSTALLATION

- 5** Slide the V-tracks at an angle into the U-channels. While doing this, manually lift the weight bar to insert the keder into the V-track, ensuring the wheels are aligned within the V-track.

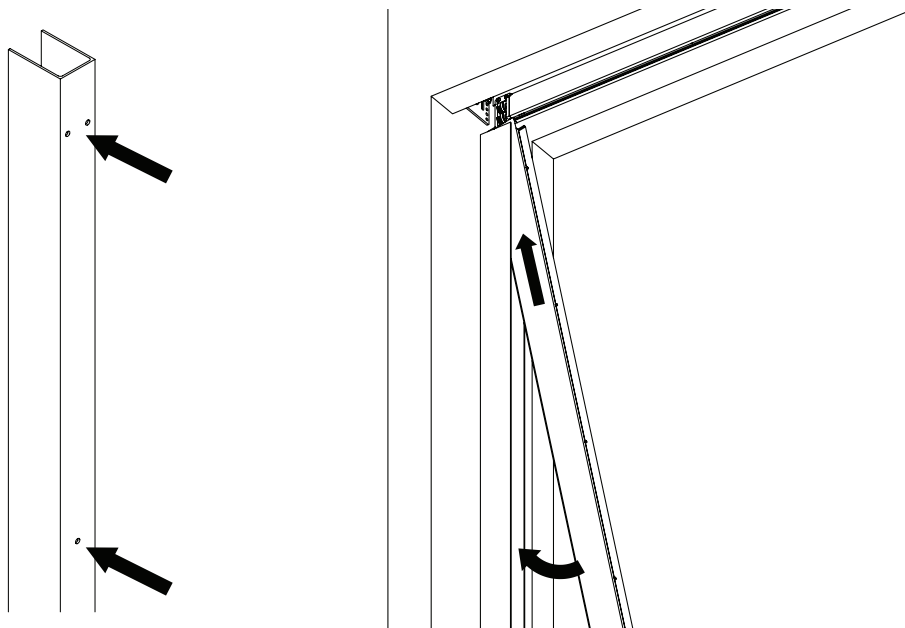

- 6** Ensure the wheels are correctly positioned and properly aligned with the track for smooth operation.

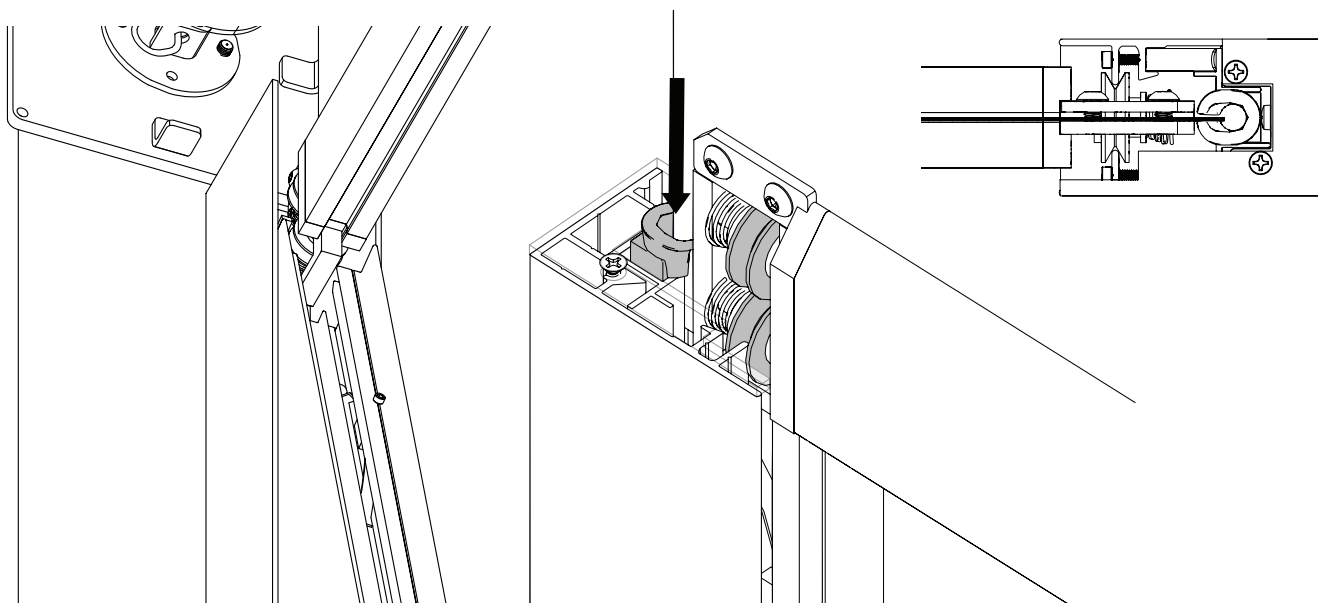

# SECURING TRACK

**Note:** Before securing the track, lower and raise the screen twice to assist with proper positioning of the track. Move the weightbar to the position you intend to secure the track. Screws should be positioned every 24 inches.

- 7** Place the track jig on the back of the U-channel, align it with the edge of the track, mark the position, and drill a hole 1.5" deep.

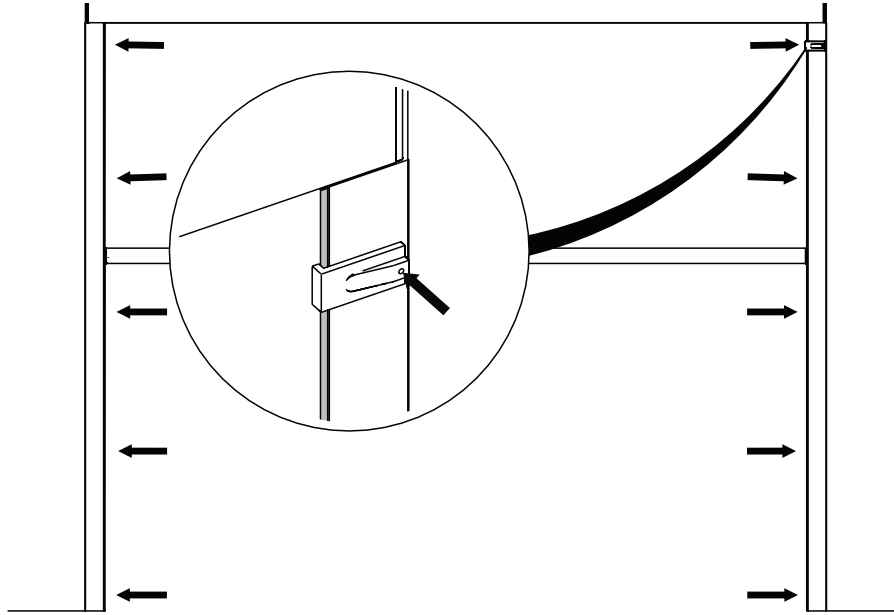

- 8** Secure the track to the U-channel using 1 1/2" flanged screws.

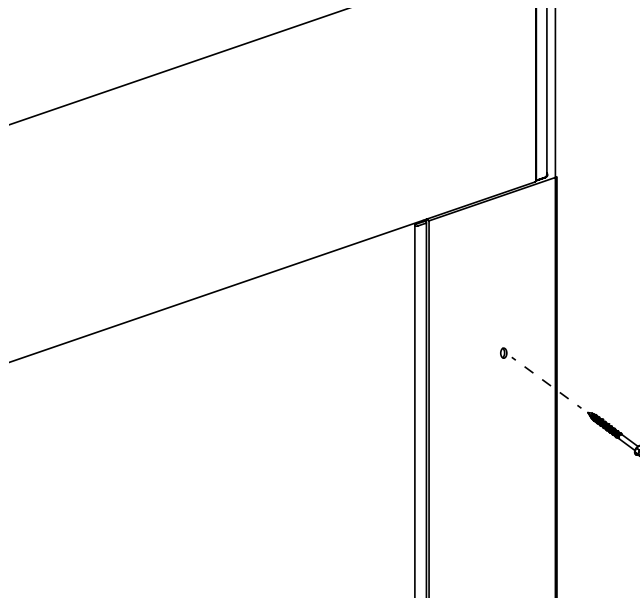

## SECURING TRACK

**11**

Install the wheel stopper as shown in the illustration to prevent the wheel system from coming off the tracks.

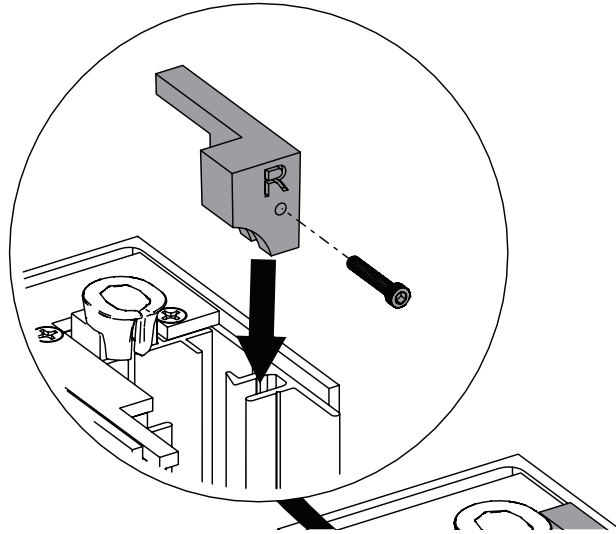

## FINE TUNING AND TRACKING MANAGEMENT

**12**

Fine Tune the Installation

- a. Fine tune the upper and lower limits. Refer to the Motor Programming Guide.
- b. Check the shade for level and the tracks for plum to ensure the fabric is rolling without telescoping or binding.

# BEST PRACTICES SUMMARY

## Tools:

- a. Use application-specific fasteners (Headlok or TORX lag screws are recommended).
- b. Ensure your miter saw blade is appropriate for cutting aluminum.

## Bracket Installation:

- a. For pocket installations, verify that the two brackets on the left and right edges are level and properly aligned.

## Measuring and Cutting:

- a. For KAOS 1.5 Pocket, follow the baseline measurement from the Measuring and Cutting the Tracks and U-Channel section.
- b. Cut one track at a time and install immediately to maintain accuracy.

## Track Installation:

- a. Ensure a slight tension is achieved when locking the track in place to secure proper fabric alignment.

## Fabric Roll Installation:

- a. Rest the weight bar on a stable surface if saw horses are not available, and ensure the fabric is properly seated before tube installation.



# TROUBLESHOOTING

Issue	Cause Possibility	Action to Take
Shade won't roll up or down completely	Motor programming issues	Reset the motor and reprogram the limits.
—	Shade isn't level	Adjust the bracket positions or re-level the installation as needed.
—	Tracks are misaligned	Verify that the U-Channels and tracks are level; adjust the locking screws if necessary.
Fabric is not tracking evenly	—	Check that the weight bar is properly seated and that the fabric is aligned in the tracks; adjust laterally if needed.

**NOTE:** Always verify all measurements, alignments, and connections against the latest product specifications before finalizing your installation.



Please use this QR Code to access the updated installation instructions and related documents on Zendesk or ask the AI chatbot.

**Technical Support:** 512.832.6939  
**Hours of Support:** 8am - 6pm CST

shadeinnovations.com  
 techsupport@shadeinnovations.com



**9715-B Burnet Rd, Suite 400 Austin, TX 78758**

**512.832.6939**

**[www.shadeinnovations.com](http://www.shadeinnovations.com)**