

Niño™ Duo Shades

Installation Instructions



INSTALLERS: PLEASE LEAVE THIS MANUAL WITH THE OWNER.





Limited 5 year warranty on Shade Innovations products

Shade Innovations warrants its products, to the original purchaser only, to be free from defects in materials and workmanship for a period of five (5) year from the date of purchase by the original purchaser provided they are properly operated according to Shade Innovations' instructions and are not damaged due to improper handling or treatment after shipment from the factory.

This warranty does not apply to equipment showing evidence of misuse, abuse, or accidental damage, or which has been tampered with or repaired by a person other than authorized Shade Innovations personnel.

Shade Innovations' sole obligation under this warranty shall be to repair or to replace (at Shade Innovations' option) the defective part of the merchandise. Returns for service should be made to your Shade Innovations' dealer. If it is necessary for the dealer to return the screen or part to Shade Innovations, transportation expenses to and from Shade Innovations are payable by the purchaser and Shade Innovations is not responsible for damage in shipment. To protect yourself against damage or loss in transit, ensure the product and prepay all transportation expenses.

This warranty is in lieu of all other warranties, express or implied, including warranties as to fitness for use and merchantability. Any implied warranties of fitness for use, or merchantability, that may be mandated by statute or rule of law are limited to the five (5) year warranty period. This warranty gives you specific legal rights, and you may also have other rights, which vary from state-to-state. No liability is assumed for expenses or damages resulting from interruption in operation of equipment, or for incidental, direct, or consequential damages of any nature.

In the event that there is a defect in materials or workmanship of a Shade Innovations product, you may contact our Sales Partners at 9715-B Burnet Road Suite 400, Austin, TX 78758, (512) 832-6939.

Important: this warranty shall not be valid and Shade Innovations shall not be bound by this warranty if the product is not operated in accordance with Shade Innovations' written instructions.

Keep your sales receipt to prove the date of purchase and your original ownership.

Problems related to electrical or motor function may require a qualified service person or electrician. For issues surrounding installation and operation, contact the

Shade Innovations Technical Service team 512.832.6939 or email at support@shadeinnovations.com



Scan the QR code to reach our Help Center

TABLE OF CONTENTS

Parts In The Box - Niño Shades 4

Outside / Inside Mount5

Installation - Inside Mount (Top Mount)..... 6 - 8

Installation - Outside Mount (Wall Mount)9 - 12

Shade Charging13

Niño Remote Settings14

Adjusting Limits.....15

Add/Remove Additional Remote15

Niño Motor Settings16

Setting The Upper And Lower Limits17

How To Put Motors To Sleep (Radio Lock).....17

Integrating Into Bond17

How To Install The Remote Holder.....18

Controls Guide Reference19

Troubleshooting..... 20

PARTS IN THE BOX – NIÑO DUO SHADES

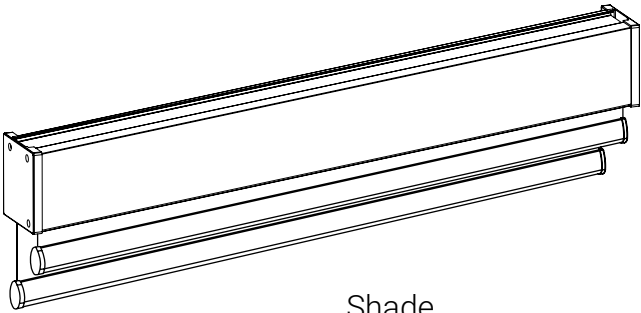

Shade

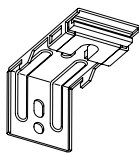

(2) Brackets

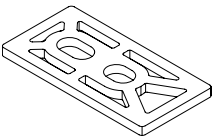

(2) Bracket
Spacers



(4) Bracket
Screws

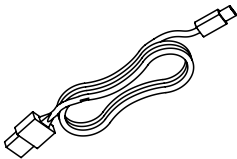

(2) USB-C
Charging Cable

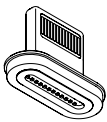

(2) USB-C
Magnetic
Adapter

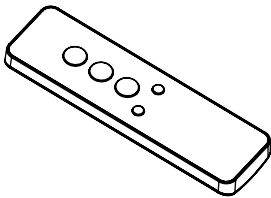

Remote

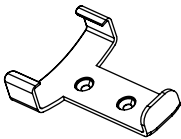

Remote Holder



AAA Battery

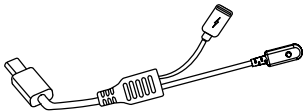

Type-C Button
Extension Cable

Required Tools for Installation

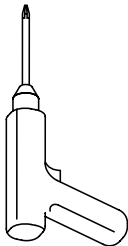
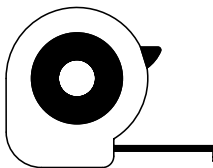
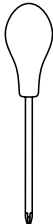
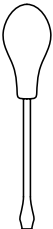
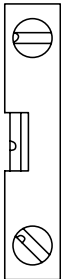

OUTSIDE / INSIDE MOUNT – NIÑO DUO SHADES

Front

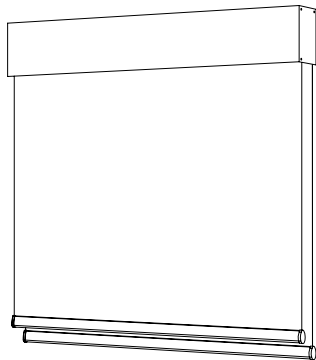

Back

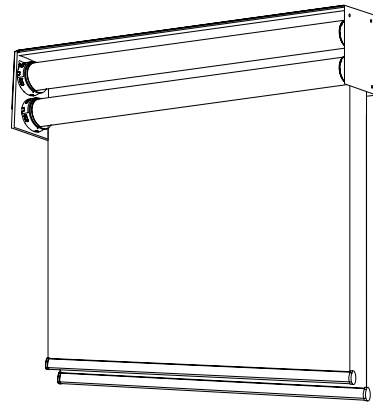

Inside Mounting

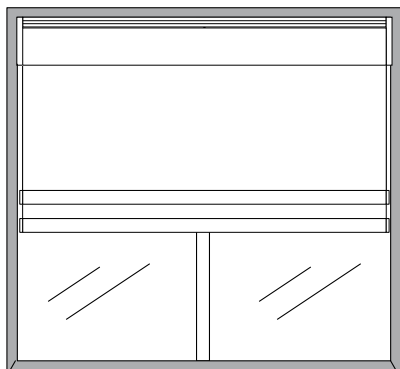

Outside Mounting

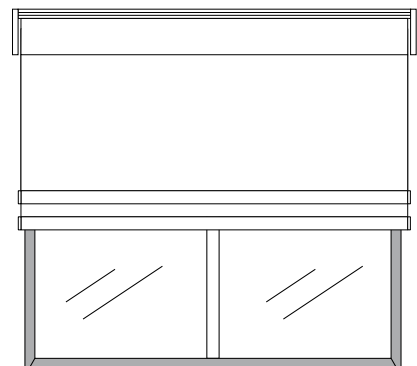

INSIDE MOUNT (TOP MOUNT) - NIÑO DUO SHADES

Detailed instructions for installation may vary.

Note: If you prefer an inside mount, proceed to next step, if you prefer outside mount, refer to page 9 it is necessary to install the brackets to the shade and position them correctly to determine where the brackets will be mounted on the wall.

Inside Mount

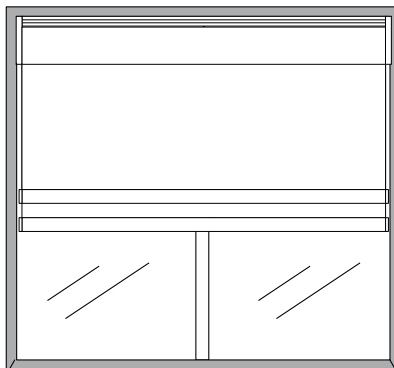

Top Mount

If you opt for an inside mount and your window frame depth allows (The window frame should have a depth of at least 3 inches.), top mount is the optimal choice.

- 1 Mark the Position.** After installing the brackets at the correct position on the shade, determine the position for the brackets on the wall and mark bracket locations with a pencil.

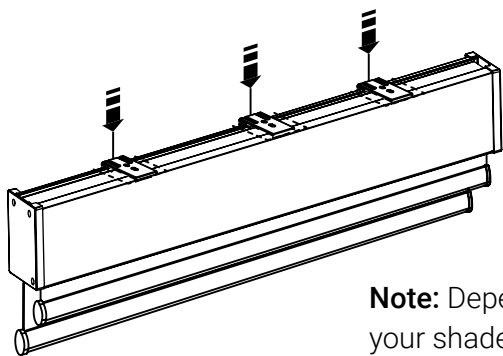

Note: Depending on the size of your shade, your box may come included more than 2 brackets.

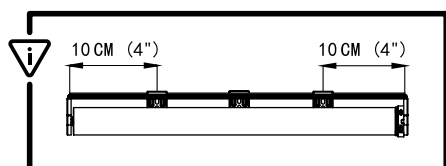
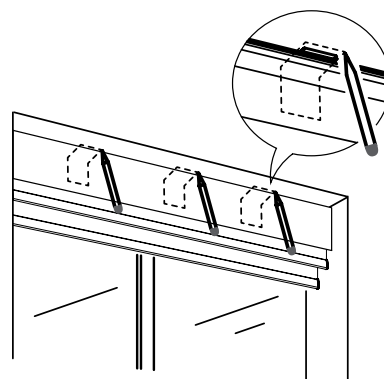

Note: The optimal position for the side caps on both sides to the center of the brackets is 10cm(4").

INSIDE MOUNT (TOP MOUNT) - NIÑO DUO SHADES

- 2 Install the Brackets.** Detach the installation brackets from the Deco bar. Then install the brackets on the wall at the pre-marked locations and secure them in place with screws.

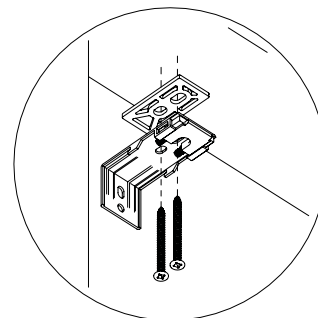
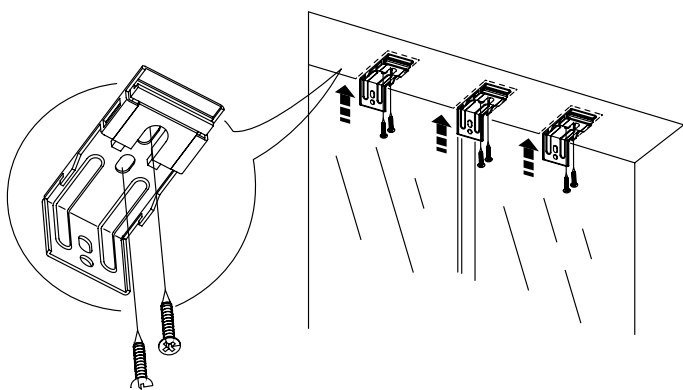

Note: Use the Spacers, if needed.

- 3 Install the Shade**

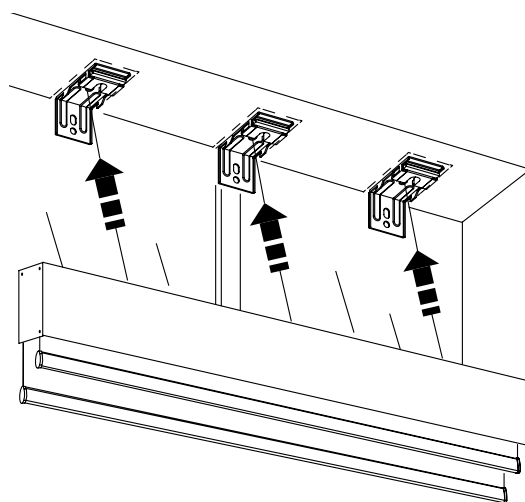

Note: To remove the shade, push against the shade and swing the shade down and out towards you, as depicted below.

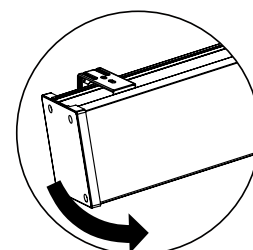
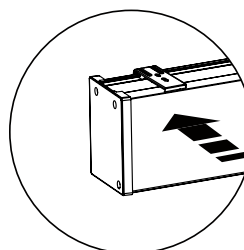
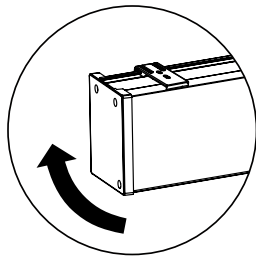
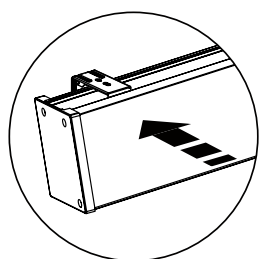

INSIDE MOUNT (TOP MOUNT) - NIÑO DUO SHADES

4 Installation Complete.

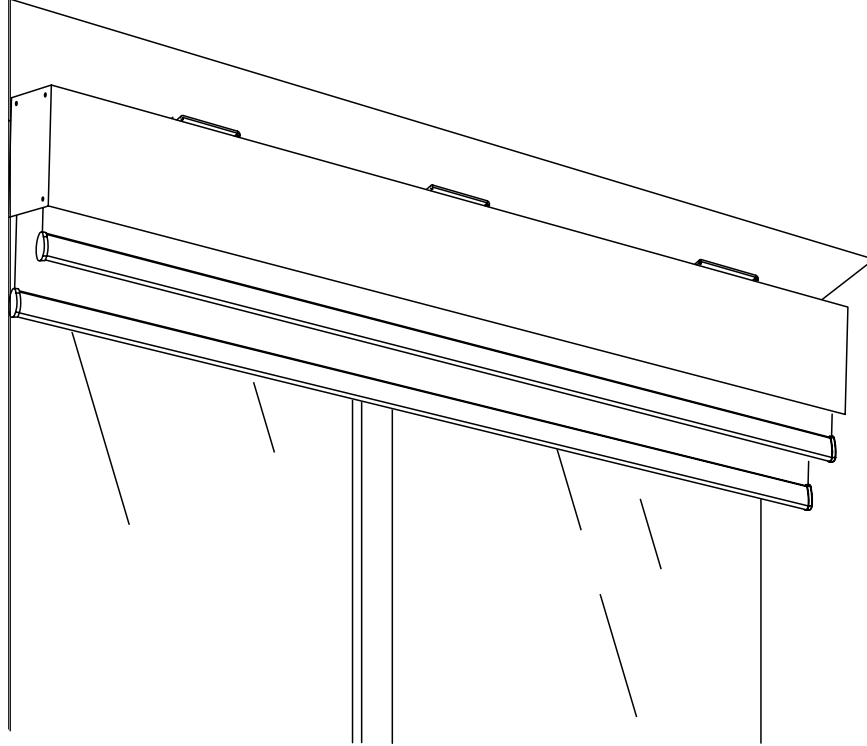

OUTSIDE MOUNT (WALL MOUNT) - NIÑO DUO SHADES

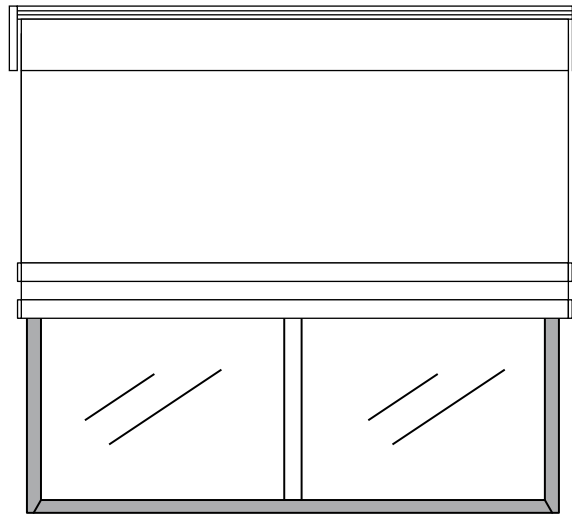

Wall Mount

Use the appropriate fasteners to securely mount the brackets.

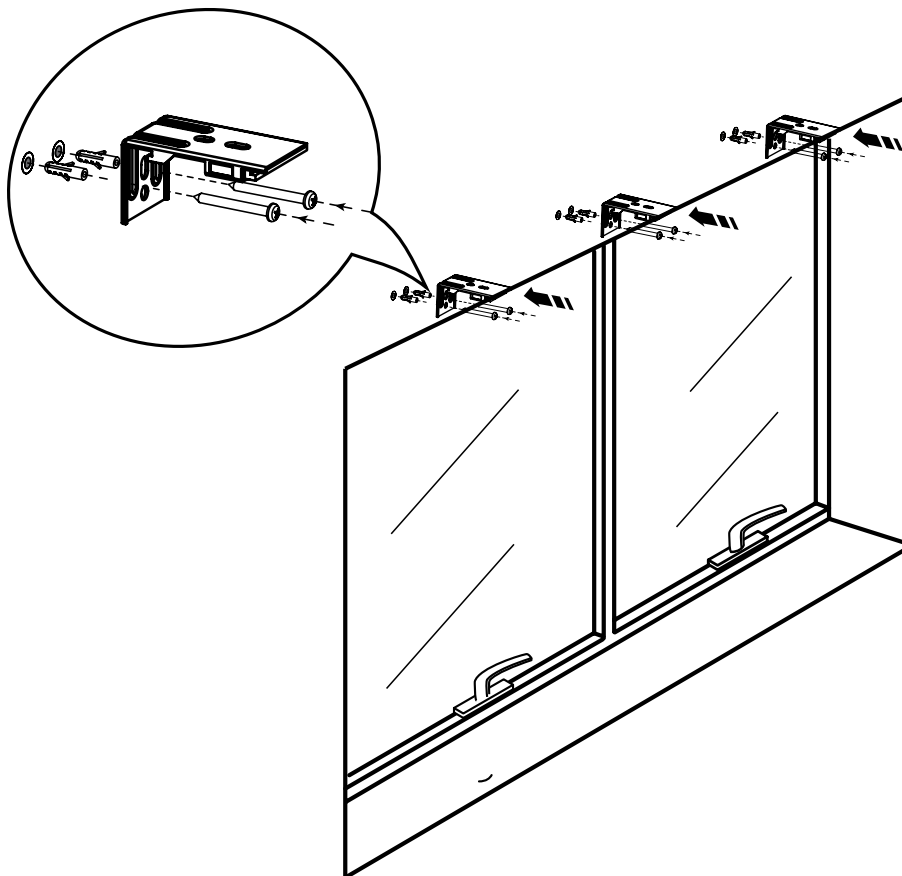

OUTSIDE MOUNT (WALL MOUNT) - NIÑO DUO SHADES

- 1 Mark the Position.** After installing the brackets at the correct position on the shade, place the shade above the window frame. Use a level to check if the shade is horizontally aligned. Finally, mark on the wall the position where the brackets will be installed.

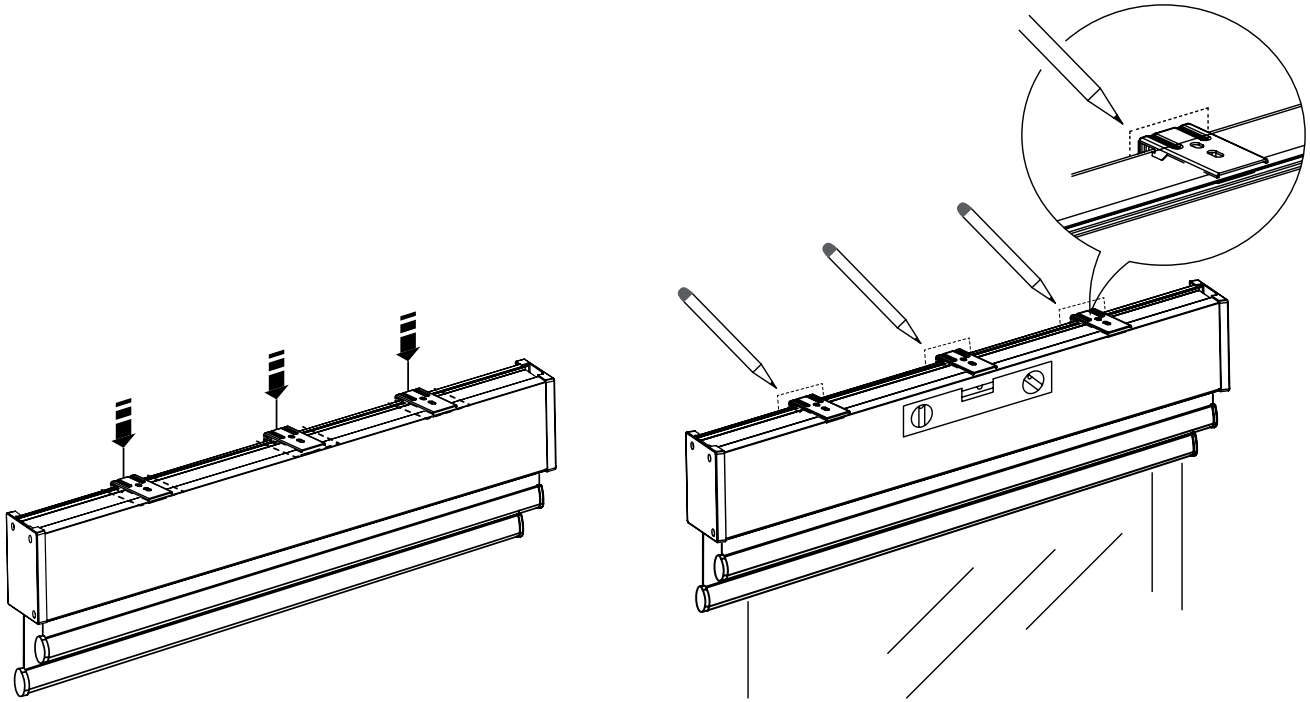

Note: The optimal position for the side caps on both sides to the center of the brackets is 10cm(4").

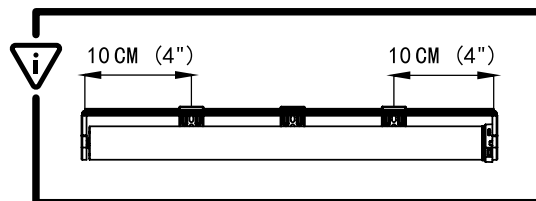

OUTSIDE MOUNT (WALL MOUNT) - NIÑO DUO SHADES

- 2** **Install the Brackets on the Wall.** Remove the brackets from the shade and secure them in place using screws at the marked locations before.

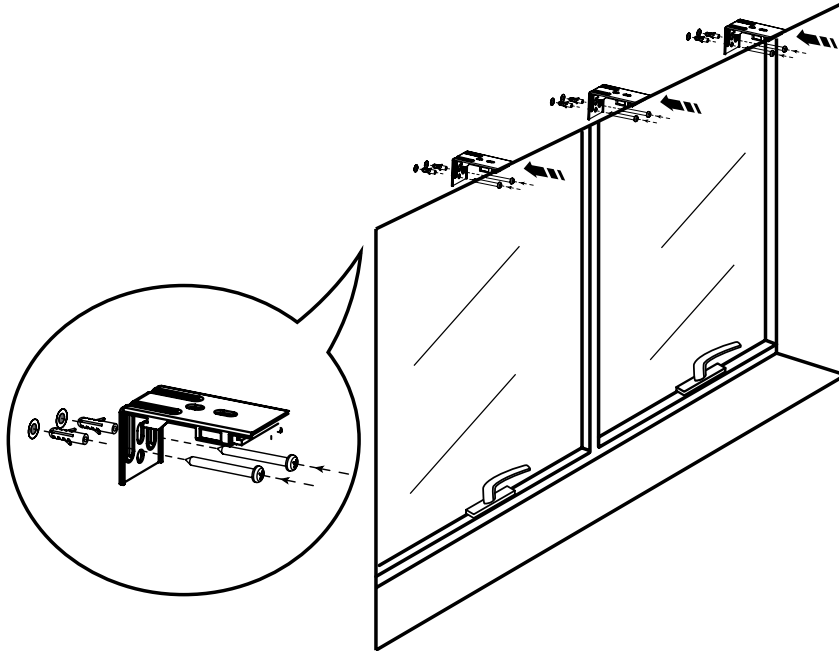

- 3** **Install the Shade.**

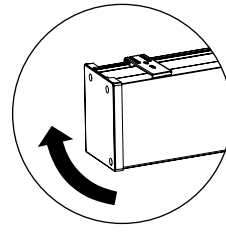
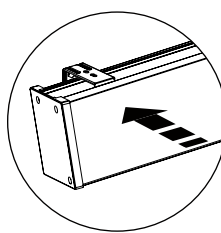
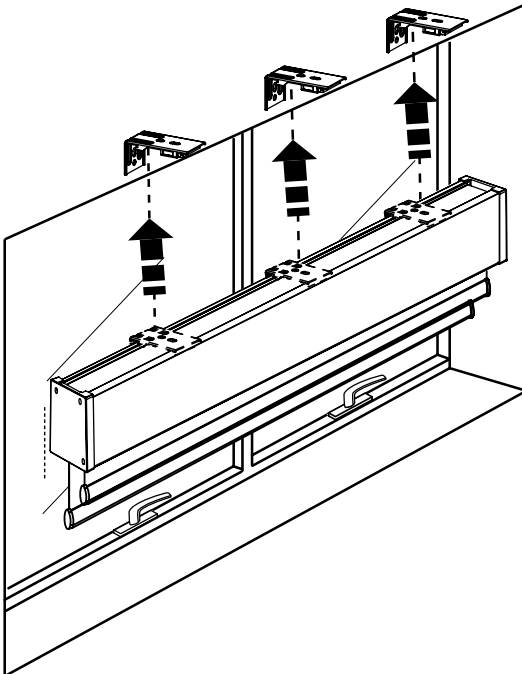

Note: To remove the shade, push against the shade and swing the shade down and out towards you, as depicted below

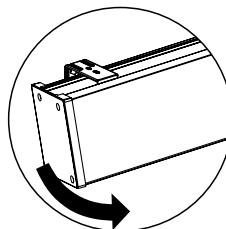
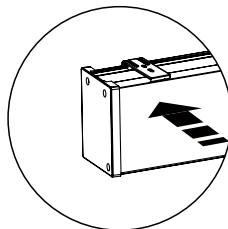

OUTSIDE MOUNT (WALL MOUNT) - NIÑO DUO SHADES

4 Installation Complete.

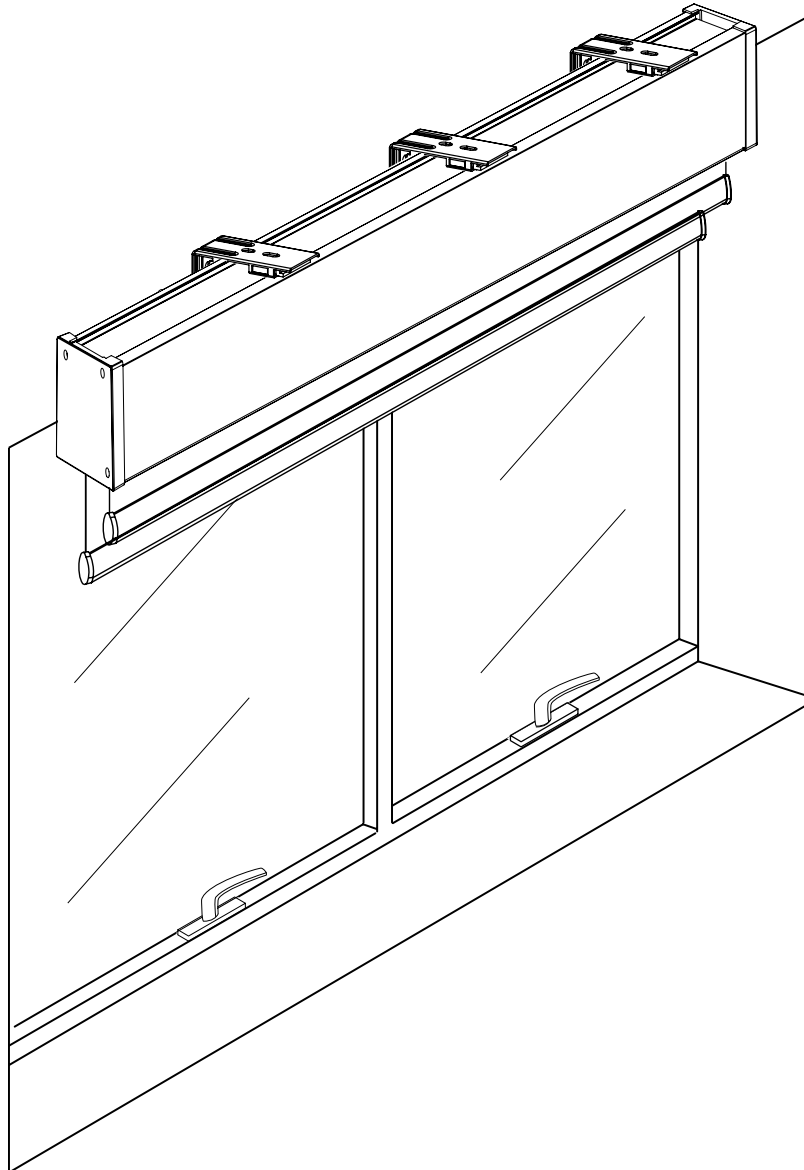

SHADE CHARGING – NIÑO DUO SHADES

Battery Powered Shades

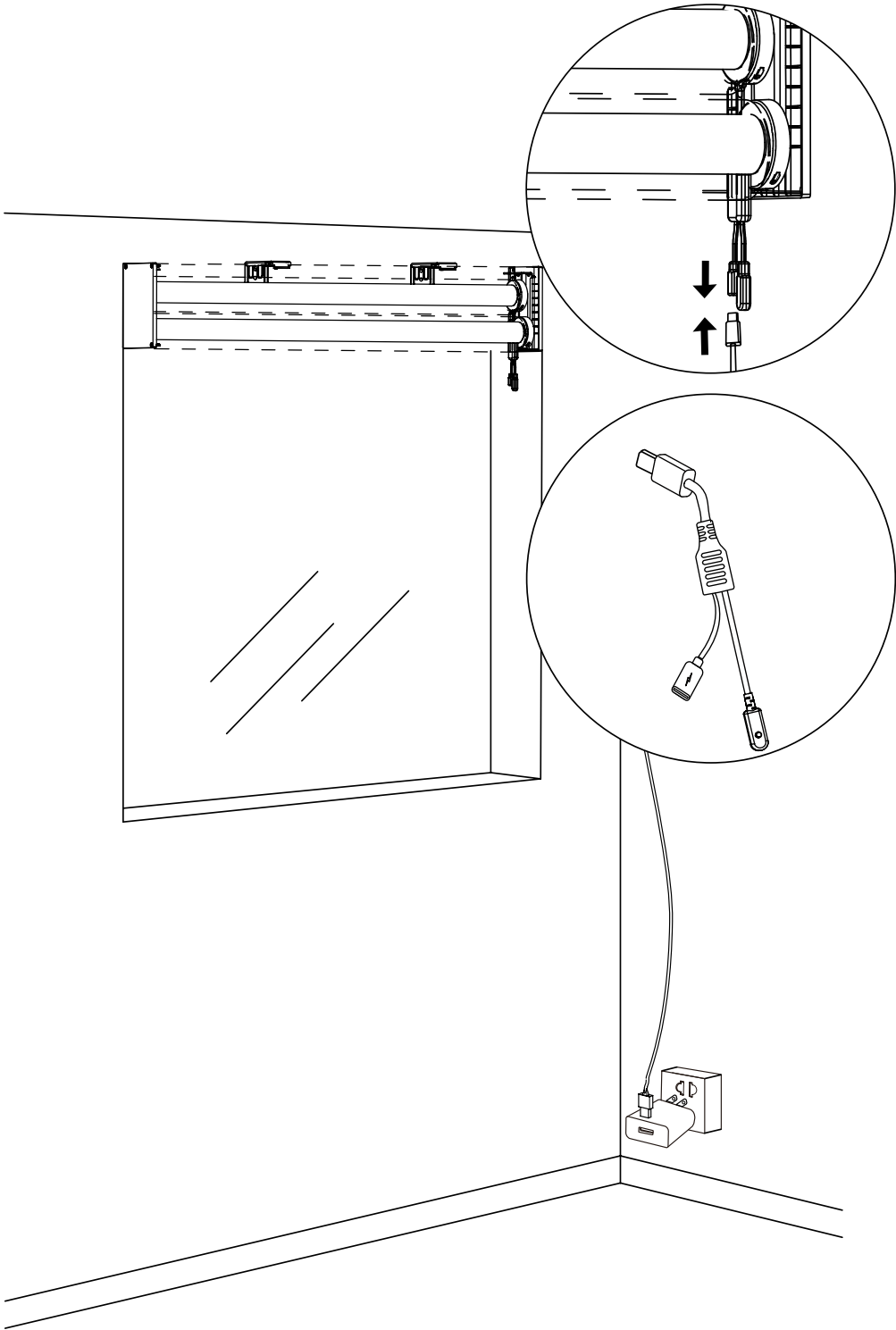

NIÑO REMOTE SETTINGS

NOTE: Shade comes with 1 channel Remote paired.

Pairing/ Unpairing a Niño Motor to a Remote

1. Press and hold programming button on the head of the motor for 1 jog.
2. Press and hold the STOP button on the remote you wish to pair, until the motor jogs. It will jog twice to confirm the remote has been set.
3. To unpair the remote, repeat this process.

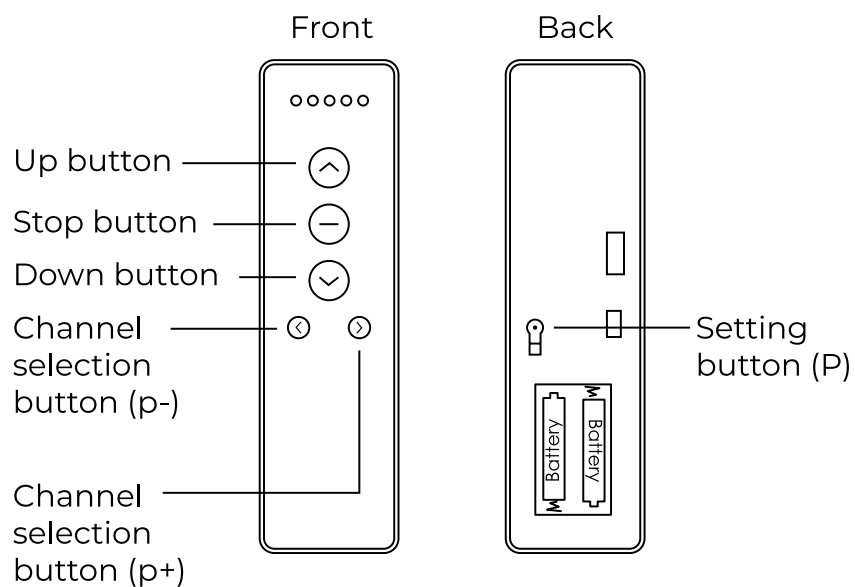

Change Niño Motor rotation

1. With no limits
 - a. Press and hold the "Up" & "Down" button on the remote until the motor jogs once.
2. With limits
 - a. Press the programming button on the back of the remote until the motor jogs once.
 - b. Simultaneously press the "Up" & "Down" button until the motor jogs once.

ADJUSTING LIMITS

NOTE: Niño shade end limits are pre-configured at the factory. If you wish to adjust the end limits, follow the steps below.

Adjusting the Upper limit

- a. Simultaneously press "Up" & "Stop" on the remote until the motor jogs once.
- b. Move the shade to the desired location.
- c. Simultaneously press "Up" & "Stop" on the remote until the motor jogs twice.

The new upper limit is now set.

Adjusting the Lower limit

- a. Simultaneously press "Down" & "Stop" on the remote until the motor jogs once.
- b. Move the shade to the desired location.
- c. Simultaneously press "Down" & "Stop" on the remote until the motor jogs twice.

The new lower limit is now set.

ADD/REMOVE ADDITIONAL REMOTE

Adding an additional remote, via an already paired remote.

- a. Press the programming button on the Remote control currently paired to the motor until the motor jogs once
- b. Again press the programming button on the Remote control currently paired to the motor until the motor jogs once
- c. Press the programming button on the new Remote control you want to add until the motor jogs twice.

This remote is now paired to the motor. Repeat this process to remove the additional remote.

NIÑO MOTOR SETTINGS

Increasing Speed

- a. Press the programming button on the back of the remote until the motor jogs once
- b. Press the "Up" button
- c. Press the "Up" button to increase speed, or "Down" to decrease speed. The motor will jog to indicate current set speed.
 - i. 1 jog level 1
 - ii. 2 jog level 2
 - iii. 3 jog level 3
- d. If motor does not respond, it has reached its maximum speed.

Decreasing Speed

- a. Press the programming button on the back of the remote until the motor jogs once
- b. Press the "Down" button
- c. Press the "Down" button to decrease speed, or "Up" to increase speed. The motor will jog to indicate current set speed.
 - i. 1 jog level 1
 - ii. 2 jog level 2
 - iii. 3 jog level 3
- d. If motor does not respond, it has reached its maximum speed.

Tilt Mode

To switch between tilt mode (moves an inch with each press) and running modes (moves continuously), ensure the shade limits are set, and then follow these steps below:

- a. Using the remote, hold the UP and DOWN buttons for around 5 seconds; the motor will jog once.
- b. After the motor jogs, press the STOP button. The motor will jog once, indicating it has entered Tilt mode.

NOTE: To return to running mode for continuous movement, simply follow the procedure outlined above again.

Factory Reset (Remove limits and remotes)

To factory reset your Niño motor, you will need to press and hold the button on the motor head, for 4 jogs. End limits and remotes are now deleted.

SETTING THE UPPER AND LOWER LIMITS.

Upper Limit:

- a. Operate the motor to the desired upper limit position
- b. Then press and hold the UP and STOP buttons together for two jogs.
- c. The lower limit is now set.

Lower Limit:

- a. Operate the motor to the desired lower limit position
- b. Then press and hold the DOWN and STOP buttons together for two jogs.
- c. The lower limit is now set.

After the limits have been set successfully, the motor will enter user mode.

HOW TO PUT MOTORS TO SLEEP (RADIO LOCK)

- a. Press and hold the motor head button for 10 seconds. The motor will jog 3 times.
- b. The motor is now Radio locked and will not accept any commands
- c. To get out of Radio lock mode, simply hold the motor head button for 1 jog.

INTEGRATING INTO BOND

NOTE: Open the Bond app and follow the On-screen instructions to add your device.

- a. To add a new device to Bond, Click the “+” button on the Top right corner of the App.
- b. Click “Add Shade” and then select your Bond Bridge.
- c. Select the Shade Innovations– Niño, then follow the On-Screen instructions.
 - i. Tap the Programming button on back of the remote for 1 jog, and then tap it again for 1 more jog.
 - ii. Click the pair button on the Bond app.
 - iii. The motor is now paired to Bond.

NOTE: Bond does not support favourite position.

HOW TO INSTALL THE REMOTE HOLDER

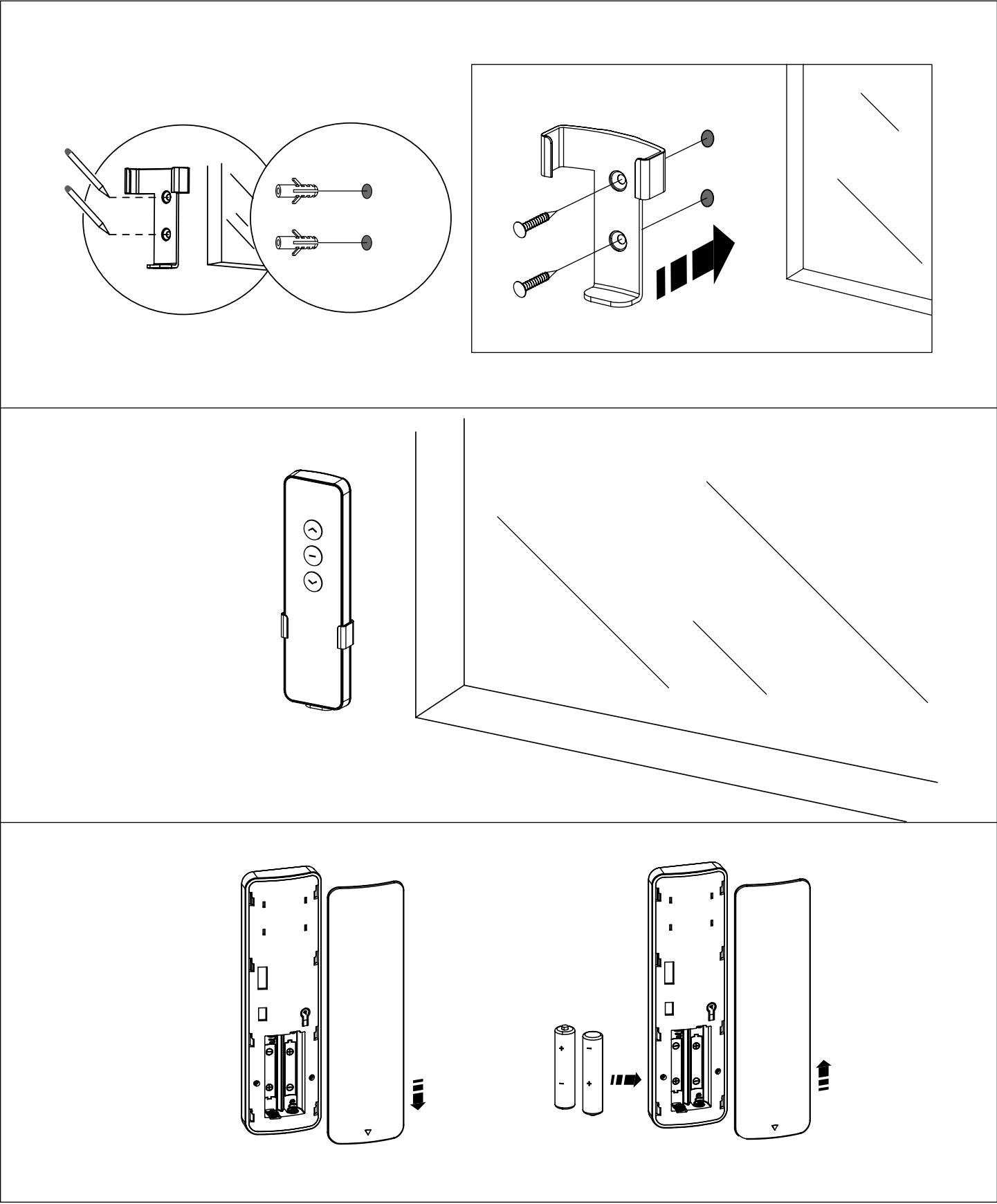

CONTROLS GUIDE REFERENCE

With each screen order, you will receive one of the Control Guides below, detailing integration with the control system.

Smart Things Instructions:

Scan the QR code; alternatively, use this link to access:

<https://files.screeninnovations.com/Downloads/Installation+Instructions/Shade/adding-Niño-shades-to-smart-things-guide.pdf>



TROY 2 Programming Guide (IP Control Gateway, 3rd Party Control System):

Scan the QR code; alternatively, use this link to access instructions and programming guide:

<https://files.screeninnovations.com/Downloads/Programming+Guides/Shade/troy-programming-guide.pdf>



5 Channel In Wall Remote Instructions:

Scan the QR code; alternatively, use this link to access:

<https://files.screeninnovations.com/Downloads/Installation+Instructions/Accessories/Niño-wall-remote-installation-instructions.pdf>



Niño Low-voltage Power Panel Installation Instructions:

Scan the QR code; alternatively, use this link to access:

<https://files.screeninnovations.com/Downloads/Installation+Instructions/Accessories/Niño-low-voltage-power-panel-installation-instructions.pdf>



Niño PoE Motor Configuration Guide:

Scan the QR code; alternatively, use this link to access:

<https://files.screeninnovations.com/Downloads/Programming+Guides/Shade/Niño-poe-motor-configuration-guide.pdf>



Problems related to electrical or motor function may require a qualified service person or electrician. For issues surrounding installation and operation, contact the

Shade Innovations Technical Service team 512.832.6939 or email at support@shadeinnovations.com



Scan the QR code to reach our Help Center

TROUBLESHOOTING

Problem	Possible Cause	Action to Take
The motor has no response.	Battery in motor is low or depleted. Power failure or incorrect connection. Remote battery is low or depleted. Radio interference. Out of radio control range.	Recharge motor with compatible AC adapter. Double check power and cable connections. Replace battery. Check that the antenna on the motor is intact and exposed. Check for possible source of radio interference. Try controlling within a closer range.
The remote can't control single motor.	Multiple motors are paired to the same channel.	Pair a single motor with the remote correctly Try to use multi-channel remotes to control multi-motor projects, ensure each channel controls one single motor.
The motor doesn't run, or starts too slowly, or makes loud noise.	Connections are incorrect. Installation is improper, or overloaded.	Double check power and cable connections. Check the motor installation.
The motor stops during up or down movements.	The motor has reached the currently set limits. The running time of the motor is more than 6 minutes.	Adjust limits if needed. Motor cannot run 6 minutes continuously, re-adjust limits or contact sales.



9715-B Burnet Rd, Suite 400 Austin, TX 78758
512.832.6939
www.shadeinnovations.com